

# STAIN GRADE VENEER FLUSH DOOR

# DESIGN OPTIONS

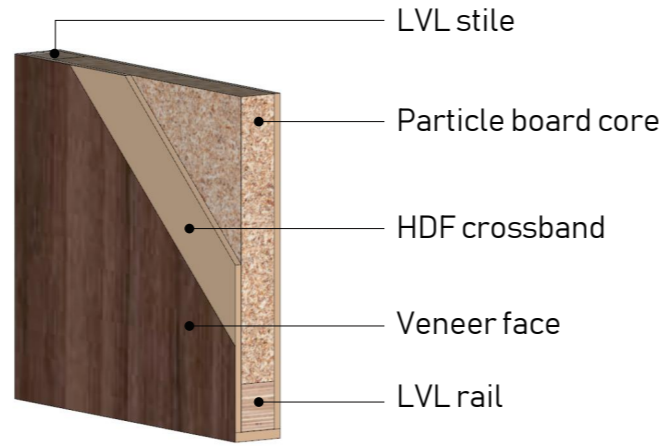

Non-rated or 20min rated



CONSTRUCTION	
General	5-ply construction, LVL stiles & rails laminated with HDF crossband
Size	Maximum height 10'-0"(3048mm), maximum width 4'-0"(1220mm)
Thickness	Standard thickness as 1-3/8"(35mm) or 1-3/4"(45mm), customized size available
CROSSBAND AND CORE	
Veneer	A or AA grade wood veneer quarter/ crown cut available
Core	Particle board core as standard, honeycomb, SCL or fire core options available
Stile&Rail	LVL or soft wood
Edge band	Solid wood or HDF
FIRE RATING	
Meets positive-pressure fire ratings: 20-, 45-, 60- and 90-minute	
FINISH OPTIONS	
Unfinished or stained finished available	



SF1-01



SF1-02



SF1-03



SF1-04



SF1-05



SF1-06



SF1-07



SF1-08



SF1-09



Sinron offers customized design services, and don't hesitate to contact our sales representatives for more information

# PAINT GRADE FLUSH DOOR

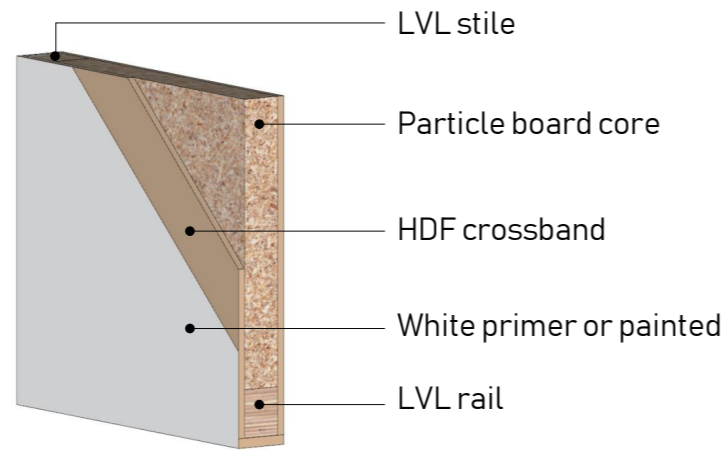

Non-rated or 20min rated



# DESIGN OPTIONS



SF2-01



SF2-02



SF2-03



SF2-04



SF2-05



SF2-06



SF2-07



SF2-08



CONSTRUCTION	
General	3-ply construction, LVL stiles & rails laminated with HDF crossband
Size	Maximum height 10'-0"(3048mm), maximum width 4'-0"(1220mm)
Thickness	Standard thickness as 1-3/8"(35mm) or 1-3/4"(45mm), customized size available
STILES AND RAILS	
Veneer	N/A
Core	Particle board core as standard, honeycomb, SCL or fire core options available
Stile&Rail	LVL or soft wood
Edge band	Solid wood or HDF
FIRE RATING	
Meets positive-pressure fire ratings: 20-, 45-, 60- and 90-minute	
FINISH OPTIONS	
Unfinished or painted, PU or water-based paint available	

Sinron offers customized design services, and don't hesitate to contact our sales representatives for more information

## HPDL FLUSH DOOR

Durability, Versatility and Easy Maintenance . Usually HPDL doors are used in high-traffic areas like hospitals and schools. HPDL doors have durable and consistent designs that make them popular for commercial spaces. Our laminate interior doors come in many colors and patterns to match the surrounding decor.

As a human-made material, HPDL has more durability than wood veneer. It also resists heat and scratches in a variety of environments. HPDL doors also withstand stains in spaces that involve liquids or dirt.

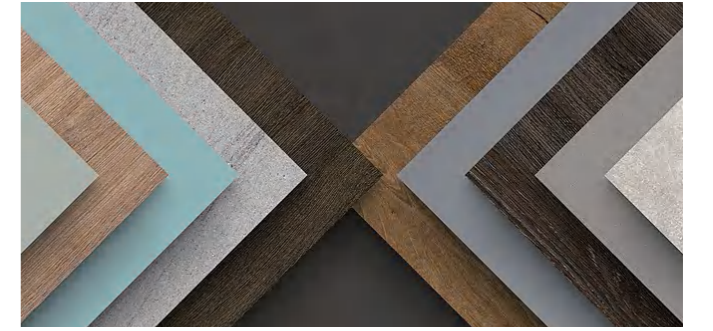
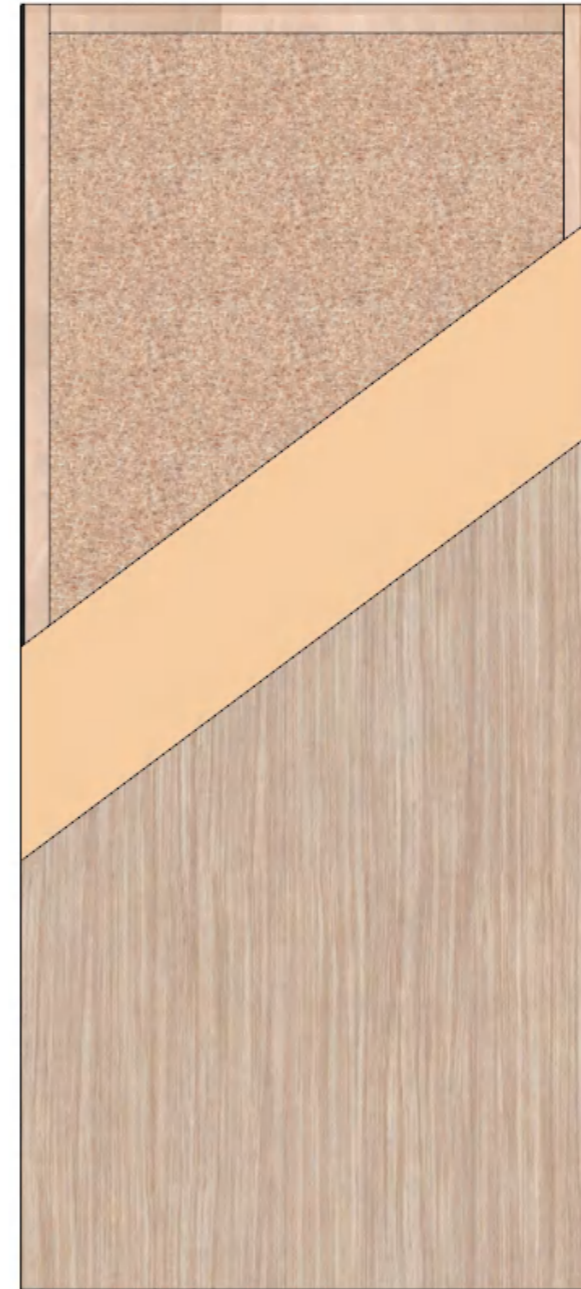

- 5-ply construction
- PVC edging matching HPDL door face
- Particleboard core, agrifiber core, are sound core and mineral core options availab
- HPDL from Wilsonart or Formica, Chinese brand also available
- Meets UL 10C positive-pressure fire ratings 20-, 45-, 60- and 90-minute
- Factory-machined to meet exact requirements for door hardware

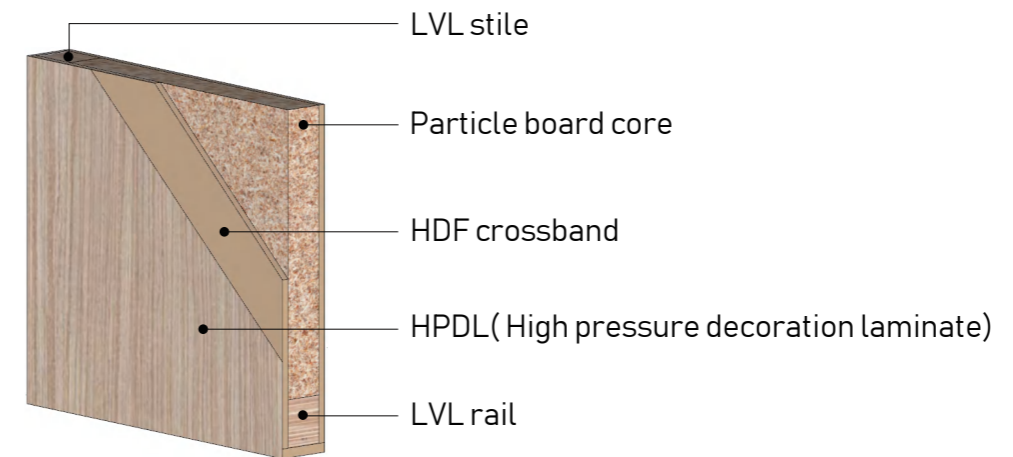

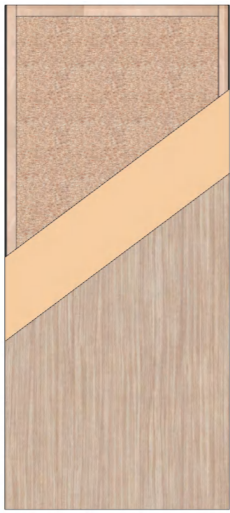
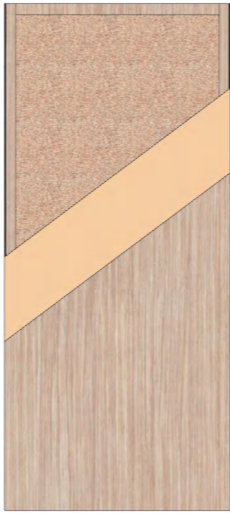
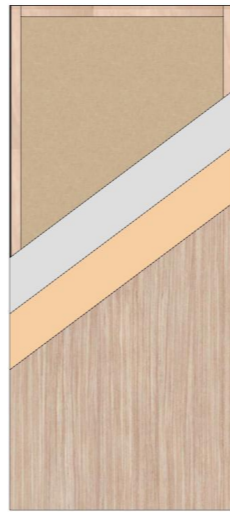
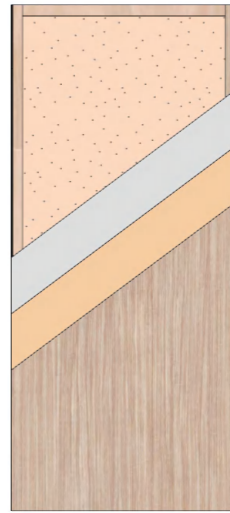
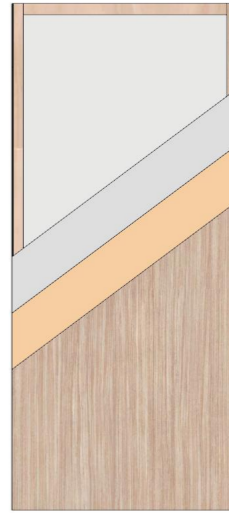
<b>DOOR CORE OPTIONS</b>						
	<b>DOOR CORE</b>	Particleboard Core	Agrifiber Core	Structural Composite Core	Acoustic Core	Mineral Core
	<b>SOUND RATING</b>	30-32 stc (32Db)	30-32 stc (32Db)	33stc (33Db)	42stc (42Db)	30-32stc (43Db)
	<b>POSITIVE PRESSURE FIRE RATING</b>	20 min	20 min	20 min	20 .45min	45.60.90 min
	<b>THICKNESS</b>	1-3/4" (45mm)	1-3/4" (45mm)	1-3/4" (45mm)	1-3/4" (45mm)	1-3/4" (45mm)
	<b>MAX SIZES</b>	Single 4' X9' Double: 8'X9'	Single 4' X9' Double: 8'X9'	Single 4' X9' Double: 8'X9'	Single 4' X9' Double: N/A	Single 4' X9' Double: 8'X8'
	<b>RAILS</b>	1-3/8" LVL	1-3/8" LVL	1-3/8" LVL	1-3/8" LVL	1-3/8" LVL
	<b>STILES</b>	1-3/8" LVL	1-3/8" LVL	1-3/8" LVL	1-3/8" LVL	1-3/8" LVL
<b>5-PLY WOOD VENEER DOORS</b>						
<b>FACES</b>	WDMA A grade or AA grade veneer, cut & species of choice, or factory primer or painted surface	WDMA A grade or AA grade veneer, cut & species of choice, or factory primer or painted surface	WDMA A grade or AA grade veneer, cut & species of choice, or factory primer or painted surface	WDMA A grade or AA grade veneer, cut & species of choice, or factory primer or painted surface	WDMA A grade or AA grade veneer, cut & species of choice, or factory primer or painted surface	
<b>CROSSBANDS</b>	High Density Fiberboard (HDF)	High Density Fiberboard (HDF)	High Density Fiberboard (HDF)	High Density Fiberboard (HDF)	High Density Fiberboard (HDF)	
<b>EDGES</b>	Matching veneer edgebanding or matching hardwood edge	Matching veneer edgebanding or matching hardwood edge	Matching veneer edgebanding or matching hardwood edge	Matching veneer edgebanding or matching hardwood edge	Matching veneer edgebanding or matching hardwood edge	
<b>HPDL(High Pressure Decorative Laminate) DOORS</b>						
<b>FACES</b>	0.7-1.2mm HPDL	0.7-1.2mm HPDL	0.7-1.2mm HPDL	0.7-1.2mm HPDL	0.7-1.2mm HPDL	
<b>CROSSBANDS</b>	High Density Fiberboard (HDF)	High Density Fiberboard (HDF)	High Density Fiberboard (HDF)	High Density Fiberboard (HDF)	High Density Fiberboard (HDF)	
<b>EDGES</b>	Customized PVC edgebands matching face HPDL	Customized PVC edgebands matching face HPDL	Customized PVC edgebands matching face HPDL	Customized PVC edgebands matching face HPDL	Customized PVC edgebands matching face HPDL	

## STILE & RAIL WOOD DOOR

## STILE & RAIL WOOD DOOR

Sinron stile and rail construction method not only gives our doors crisp, clean lines that are architecturally correct, but it also enables greater versatility to build virtually any door style. The components of stile and rail doors can be combined to create the configuration you desire. The figure below illustrates stile and rail construction.

And with various custom design options to choose from, there is a stile and rail door that's perfect for your projects.

- Various of sticking and panel profile options
- LVL core as standard with HDF crossband, particle board and solid wood core available
- Meets UL 10C positive-pressure fire ratings: 20-, 45-, 60- and 90-minute
- Different glass insert available to offer a true divided lite option
- WDMA TR-6 Catalyzed polyurethane finish as standard, primed and opaque coatings also available
- Factory-machined to meet exact requirements for door hardware

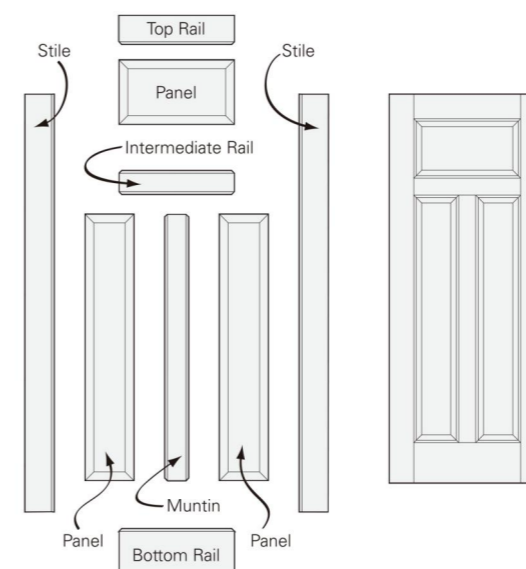

# STILE & RAIL -VENEERED STYLE

# DESIGN OPTIONS

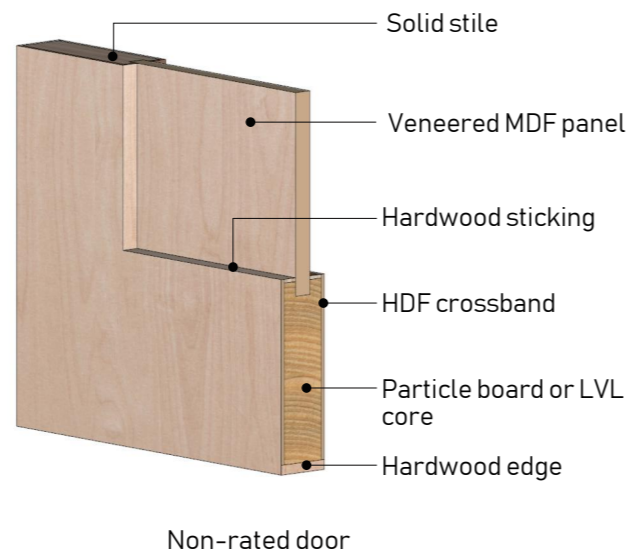

CONSTRUCTION	
General	Composite stile & rail connected by tongue and groove construction
Size	Maximum height 10'-0"(3048mm), maximum width 4'-0"(1220mm)
Thickness	Standard thickness as 1-3/8"(35mm) or 1-3/4"(45mm), customized size available
STILES AND RAILS	
Veneer	A or AA grade wood veneer quarter/ crown cut available
Core	Finger-joint softwood or particle board laminated with HDF crossbanding
Sticking	Solid hardwood, customized profile available
Edge band	Solid wood or HDF
PANEL	
MDF with veneer applied, customized panel profile available. Glass panel available	
FINISH OPTIONS	
Unfinished or painted, PU or water-based paint available	



SS1-01



SS1-02



SS1-03



SS1-04



SS1-05



SS1-06



SS1-07



SS1-08

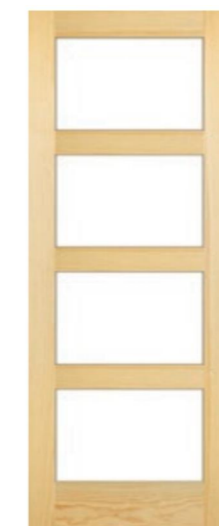

SS1-09



SS1-10

# STILE & RAIL -VENEERED TRADITIONAL STYLE

# DESIGN OPTIONS

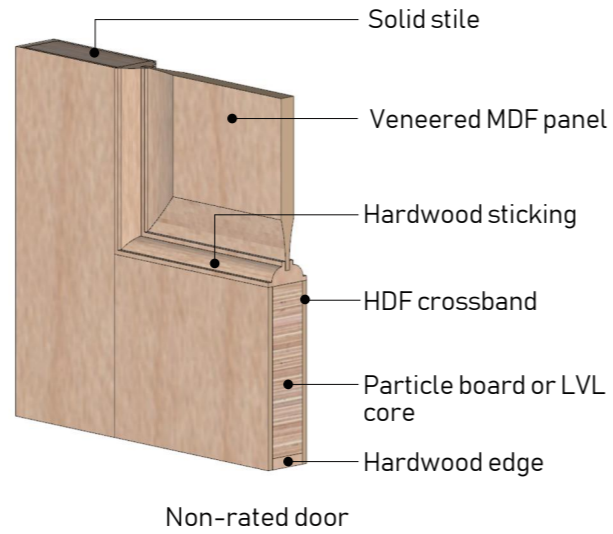

SS2-01



SS2-02



SS2-03



SS2-04



SS2-05



SS2-06



CONSTRUCTION	
General	Composite stile & rail connected by tongue and groove construction
Size	Maximum height 10'-0"(3048mm), maximum width 4'-0"(1220mm)
Thickness	Standard thickness as 1-3/8"(35mm) or 1-3/4"(45mm), customized size available
STILES AND RAILS	
Veneer	A or AA grade wood veneer quarter/ crown cut available
Core	Finger-joint softwood or particle board laminated with HDF crossbanding
Sticking	Solid hardwood, customized profile available
Edge band	Solid wood or HDF
PANEL	
MDF with veneer applied, customized panel profile available. Glass panel available	
FINISH OPTIONS	
Unfinished or painted, PU or water-based paint available	



SS2-07



SS2-08



SS2-09

# STILE & RAIL DOOR- PANINT GRADE STYLE

# DESIGN OPTIONS

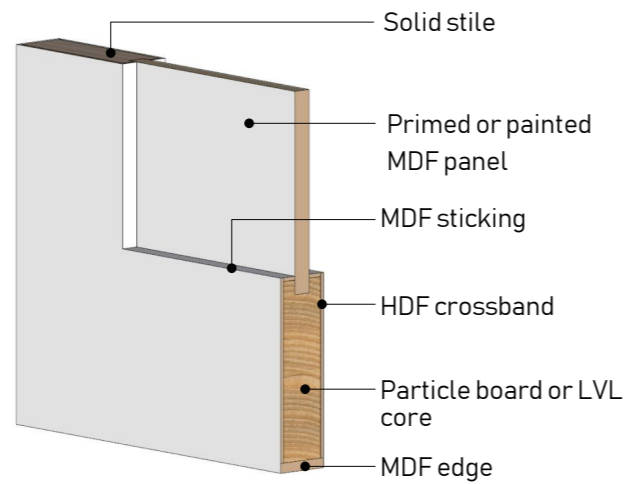

Non-rated door



CONSTRUCTION	
General	Composite stile & rail connected by tongue and groove construction
Size	Maximum height 10'-0"(3048mm), maximum width 4'-0"(1220mm)
Thickness	Standard thickness as 1-3/8"(35mm) or 1-3/4"(45mm), customized size available
STILES AND RAILS	
Veneer	N/A
Core	Finger-joint softwood or particle board laminated with HDF crossbanding
Sticking	Solid hardwood, customized profile available
Edge band	Solid wood or HDF
PANEL	
MDF panel, customized panel profile available. Glass panel available	
FINISH OPTIONS	
White primed or painted, PU or water-based paint available	



SS3-01

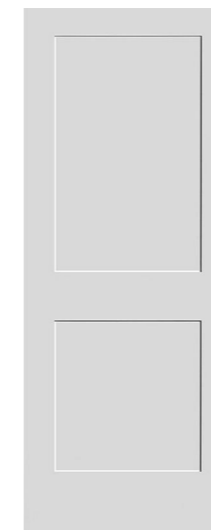

SS3-02

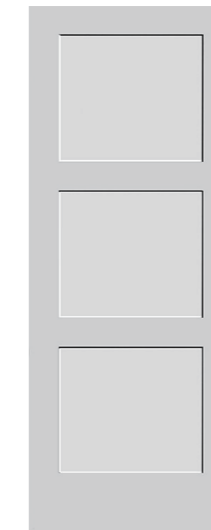

SS3-03

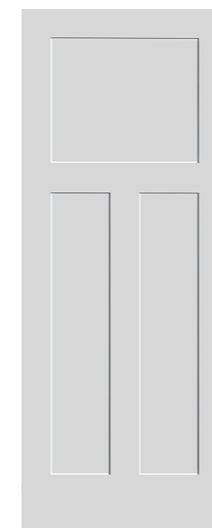

SS3-04



SS3-05

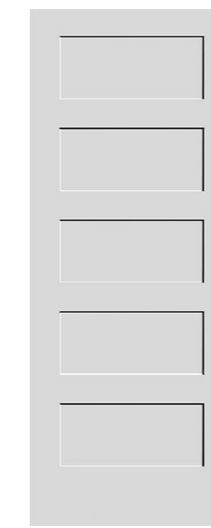

SS3-06



SS3-07

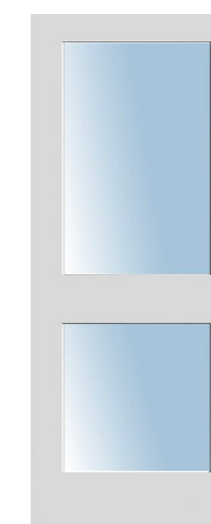

SS3-08

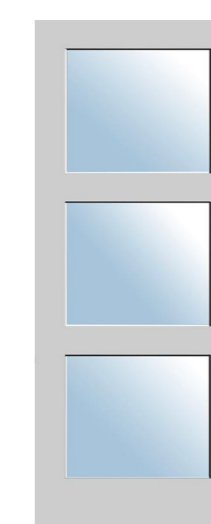

SS3-09

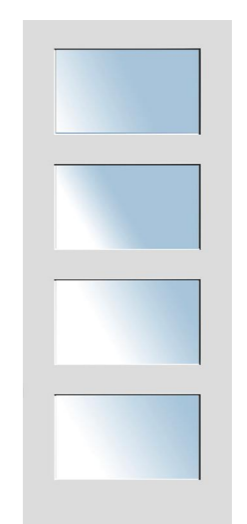

SS3-10

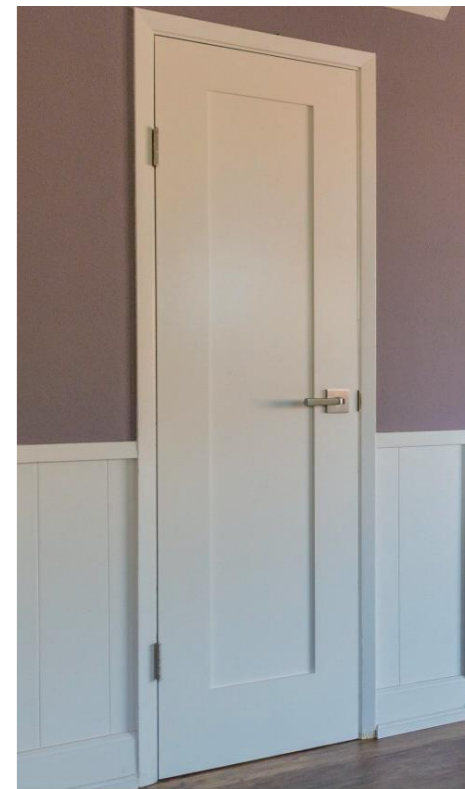

# STILE & RAIL DOOR- LOUVER DOOR

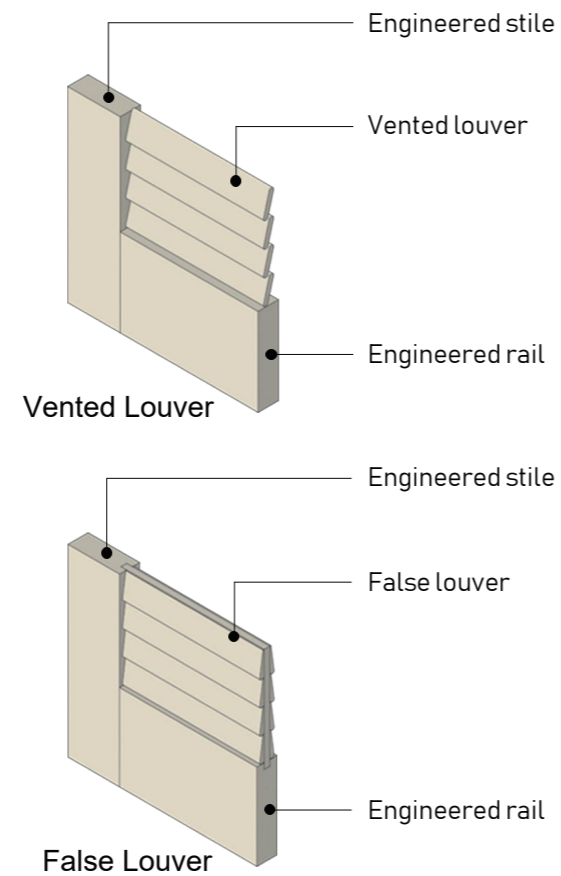

## DESIGN OPTIONS

### MDF LOUVER



SS3-01

SS3-02

SS3-03

SS3-04

### SOLID WOOD LOUVER



SS3-05

SS3-06

SS3-07

SS3-08

CONSTRUCTION	
General	Composite stile & rail connected by tongue and groove construction
Size	Maximum height 10'-0"(3048mm), maximum width 4'-0"(1220mm)
Thickness	Standard thickness as 1-3/8"(35mm) or 1-3/4"(45mm), customized size available
STILES AND RAILS	
Veneer	N/A
Core	Finger-joint softwood or particle board laminated with HDF crossbanding
Sticking	Solid hardwood, customized profile available
Edge band	Solid wood or HDF
PANEL	
MDF louver or solid wood louver, customized panel profile available.	
FINISH OPTIONS	
White primed or painted, PU or water-based paint available	



# PROFILE DESIGN OPTIONS

## STICKING PROFILE OPTIONS

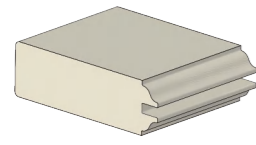

Ogee

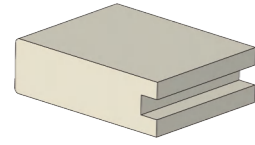

Square

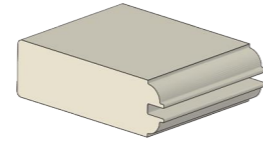

Quarter Round

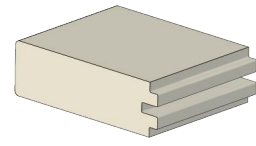

One Step

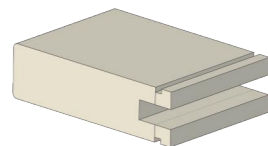

Quirk Moulding

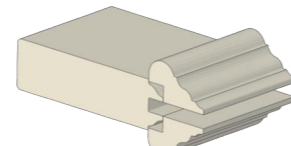

Bolection Moulding

## PANEL PROFILE OPTIONS

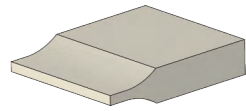

Raised "A"

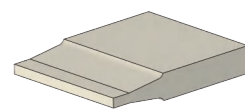

Raised "B"

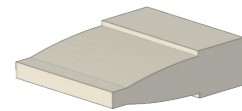

Raised "C"

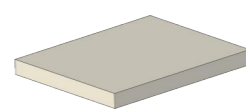

Flat

## GLASS DOOR PROFILE OPTIONS

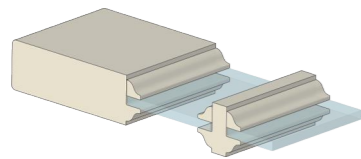

Raised "A"

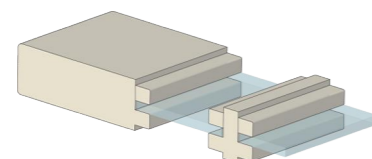

Raised "B"

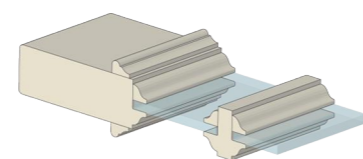

Raised "C"

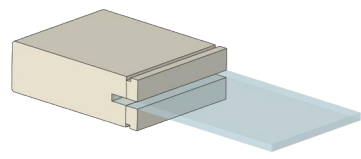

Raised "B"

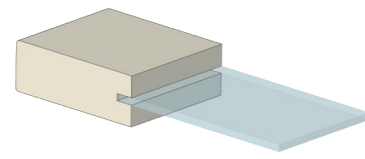

Raised "B"

# CUSTOMIZED DESIGN OPTIONS

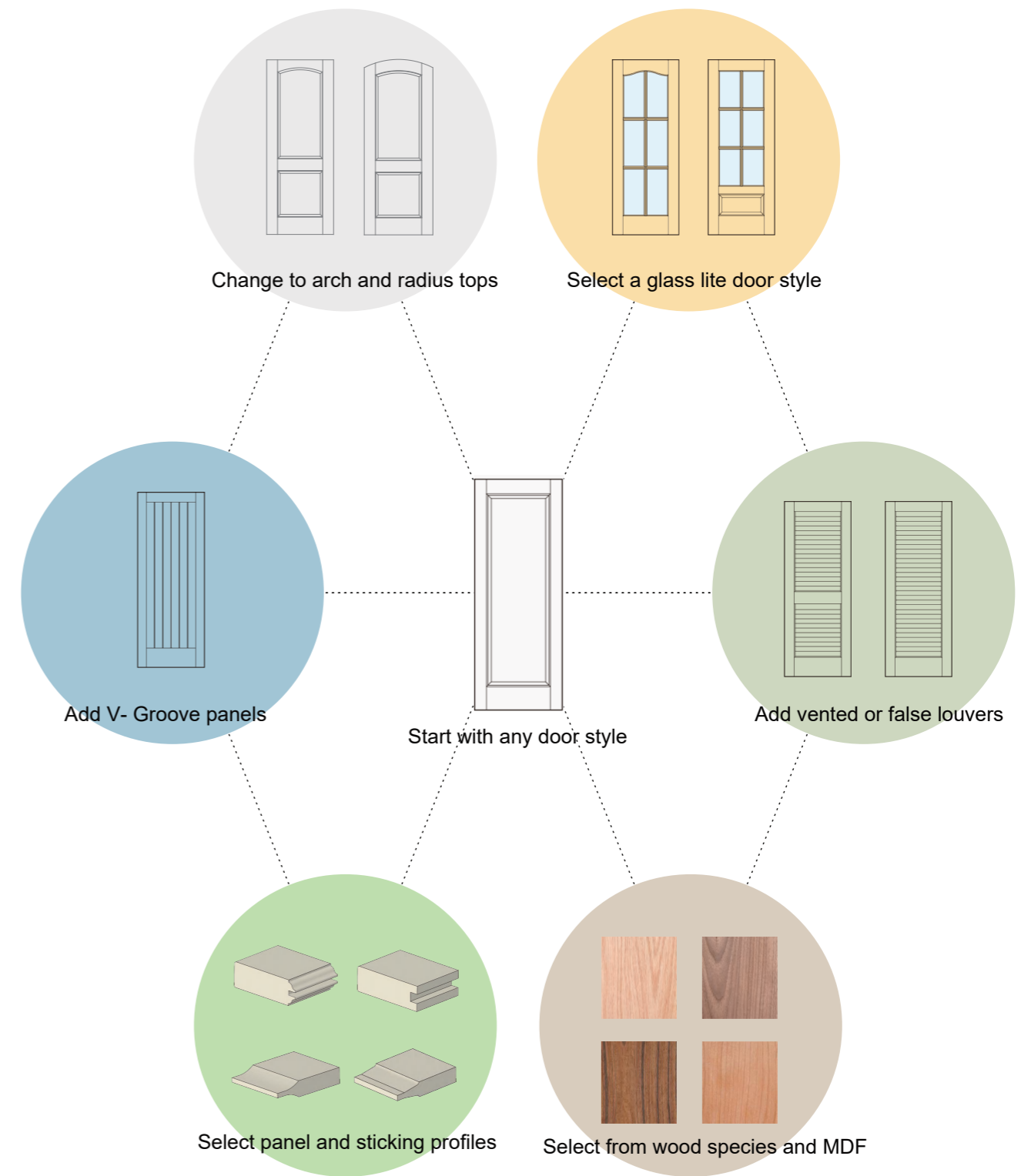

# STANDARD ELEVATION OPTIONS

## PANEL DOOR OPTIONS

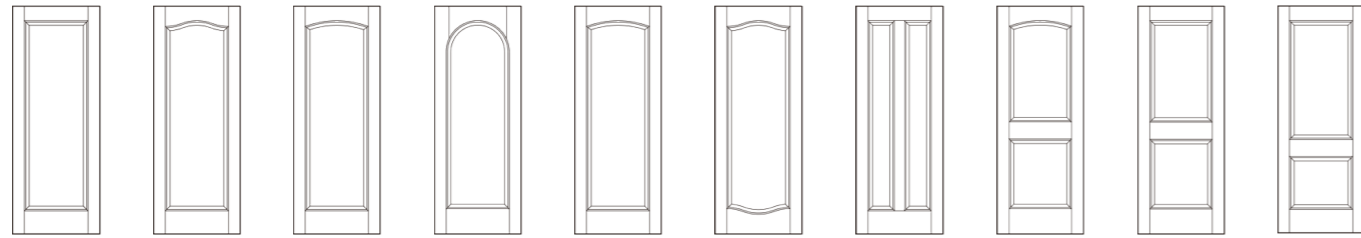

SW-01 SW-02 SW-03 SW-04 SW-05 SW-06 SW-07 SW-08 SW-09 SW-10

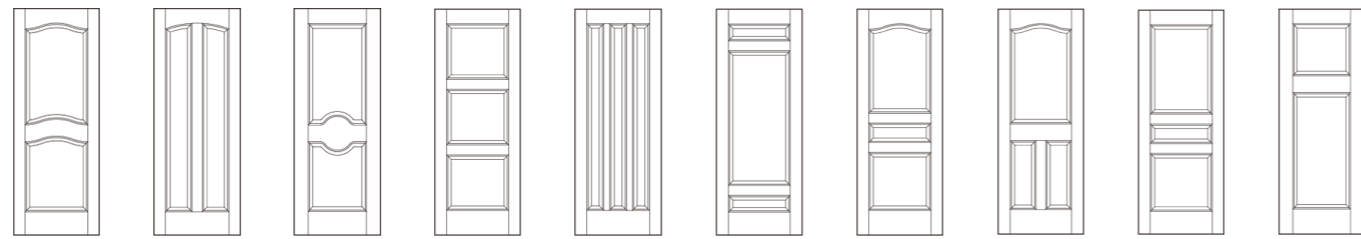

SW-11 SW-12 SW-13 SW-14 SW-15 SW-16 SW-17 SW-18 SW-19 SW-20

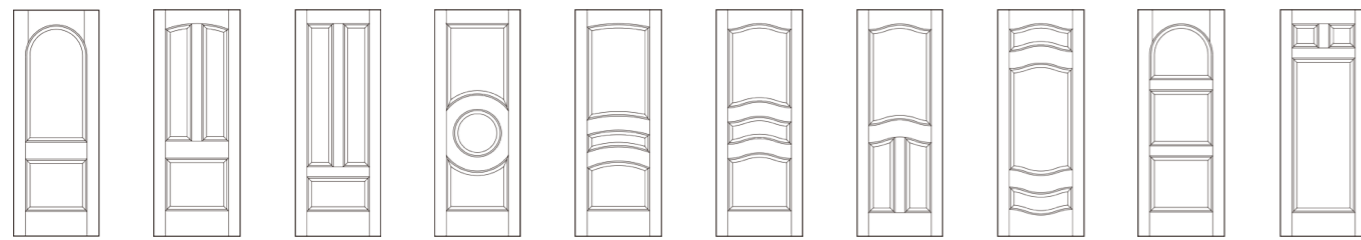

SW-21 SW-22 SW-23 SW-24 SW-25 SW-26 SW-27 SW-28 SW-29 SW-30

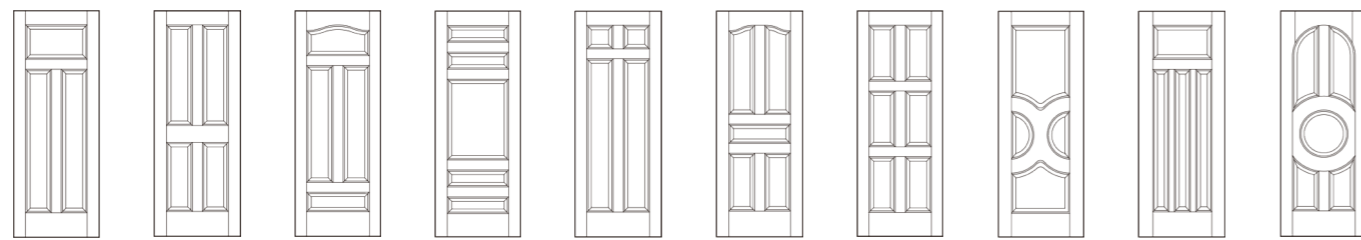

SW-31 SW-32 SW-33 SW-34 SW-35 SW-36 SW-37 SW-38 SW-39 SW-40

## GROOVED PANEL OPTIONS

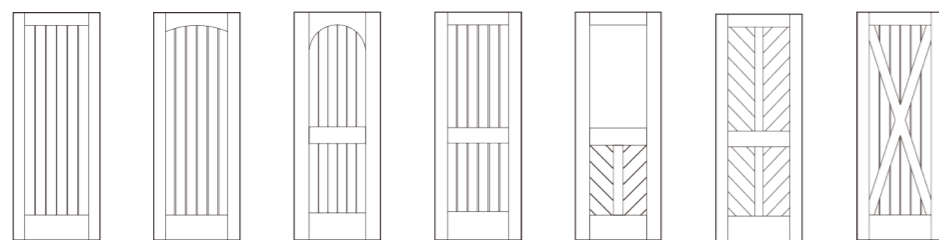

SC-01 SC-02 SC-03 SC-04 SC-05 SC-06 SC-07

## GLASS DOOR OPTIONS

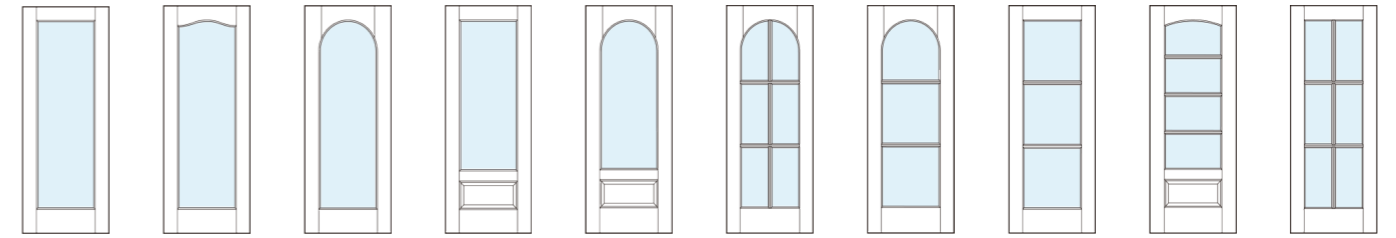

SG-01 SG-02 SG-03 SG-04 SG-05 SG-06 SG-07 SG-08 SG-09 SG-10

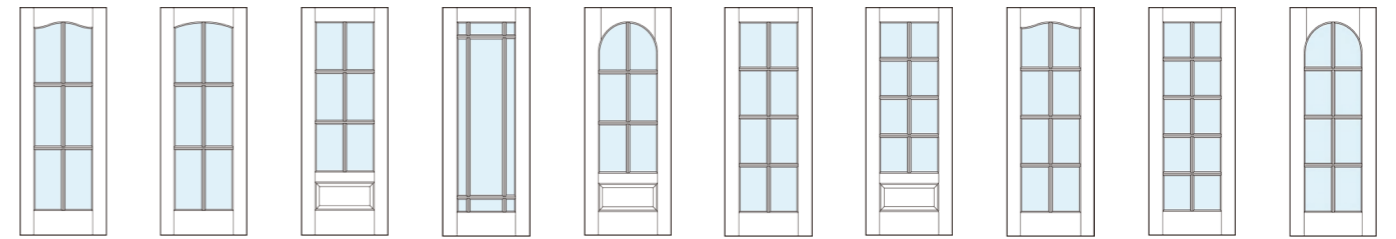

SG-11 SG-12 SG-13 SG-14 SG-15 SG-16 SG-17 SG-18 SG-19 SG-20



SG-21 SG-22 SG-23 SG-24 SG-25 SG-26 SG-27 SG-28 SG-29 SG-30

## LOUVER DOOR OPTIONS

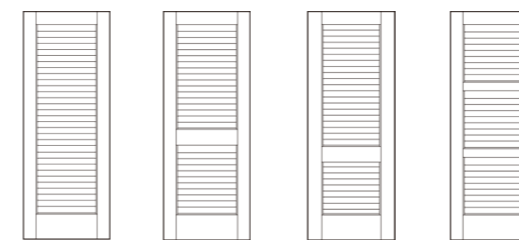

SL-01 SL-02 SL-03 SL-04

Sinron offers customized design services, and don't hesitate to contact our sales representatives for more information

# ROUTER CARVED WOOD DOOR

## MDF ROUTER CARVED WOOD DOOR

Sinron MDF router carved doors are constructed as 2 medium density fiberboard(MDF) skins with a core in the middle. This stable construction is an environmentally friendly substrate that will not split or warp and provides a smooth, paintable surface.

The MDF router carved door is offered in a wide variety of styles to fit many different architectural styles. There are over 200 standard designs plus unlimited custom design flexibility for homeowners and builders to choose from.

- 3 or 5 -Ply construction
- High density fiberboard surface, providing unrivaled smoothness and finishing
- Primer or catalyzed polyurethane finish to meet WDMA OP-6.
- Standard thickness is 1-3/8" or 1-3/4", customized size available.
- Wood veneered and stained finished also available.
- Meets UL 10C positive-pressure fire ratings: 20-, 45-minute
- Unlimited design options, including most graphics and text.
- Factory-machined to meet exact requirements for door hardware.



# MDF ROUTER CARVED WOOD DOOR

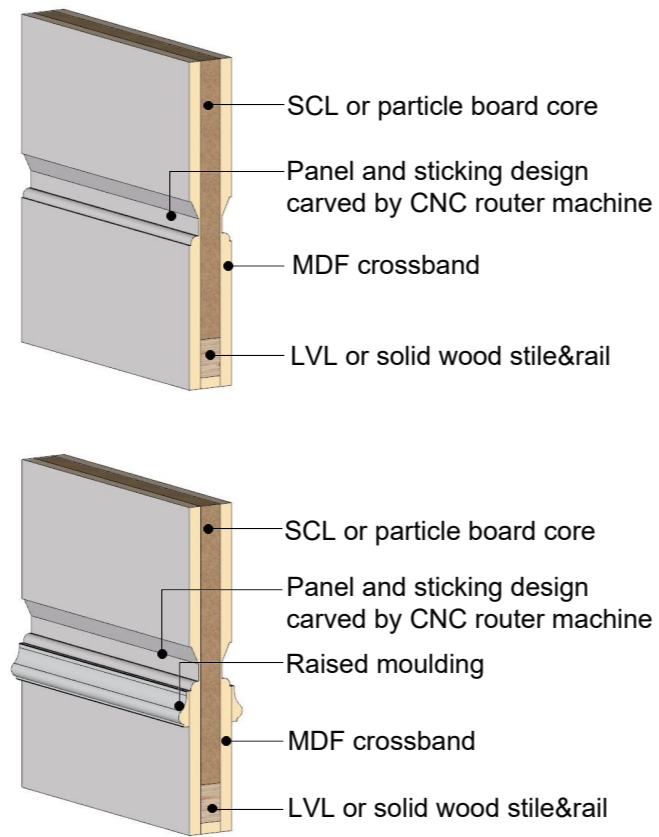

# DESIGN OPTIONS

## STANDARD

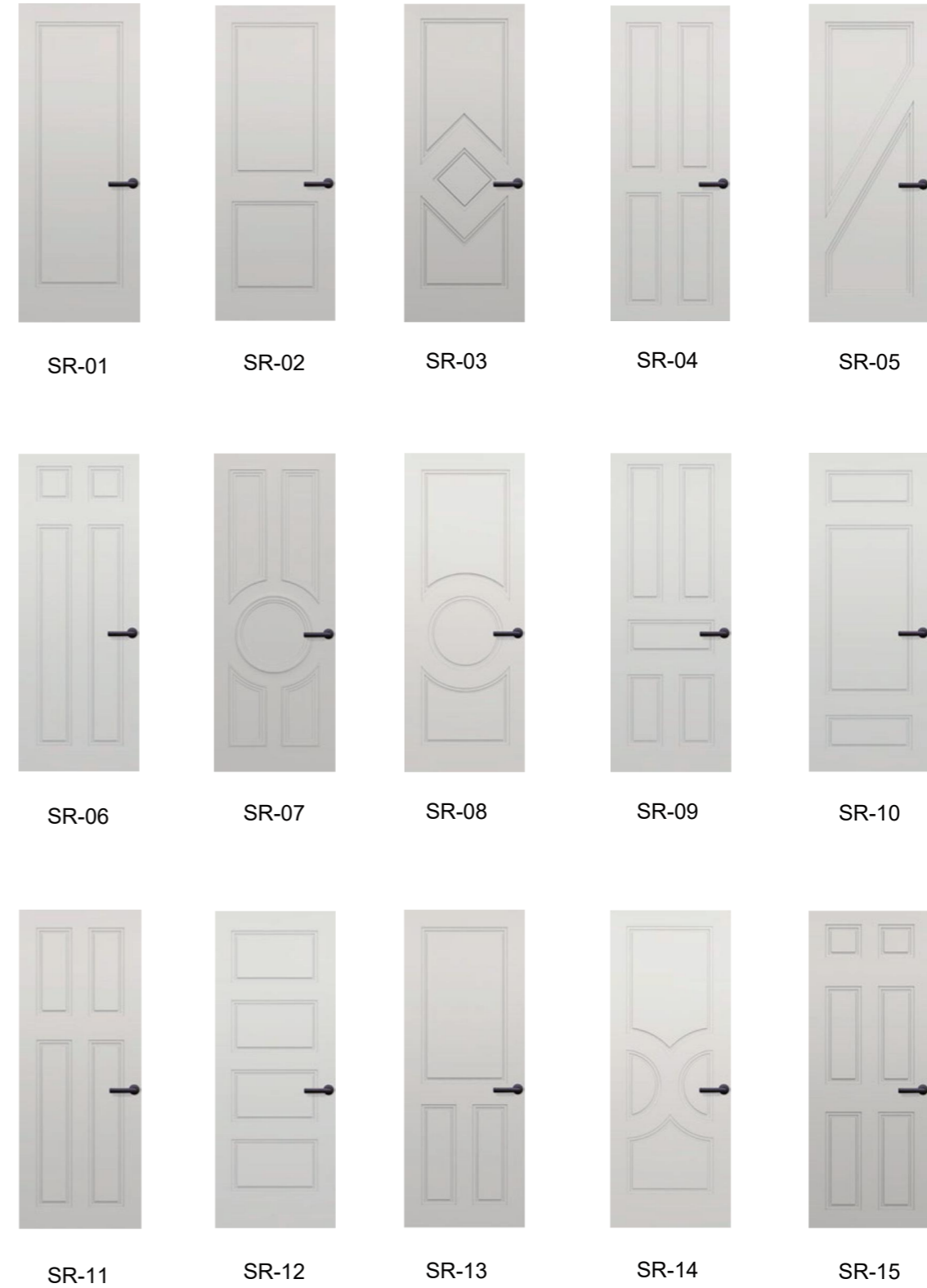

CONSTRUCTION	
General	Sandwich construction, designs routed by CNC machine
Size	Maximum height 10'-0"(3048mm), maximum width 4'-0"(1220mm)
Thickness	Standard thickness as 1-3/8"(35mm) or 1-3/4"(45mm), customized size available
Veneer	White painted or Red oak, cherry, Walnut, mahogany etc
SKELETON & CORE	
Skeleton	Finger-joint softwood or LVL
Core	SCL, solid wood or particleboard core
Crossband	HDF
PROFILE AND PANEL	
Customized profile and panel available. Customized raised moulding profile available.	
FINISH OPTIONS	
Unfinished or painted, PU or water-based paint available	

### RAISED MOULDING OPTIONS

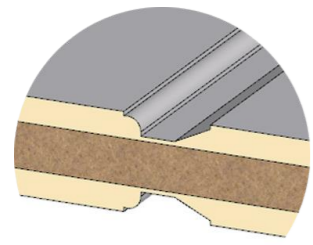

Standard

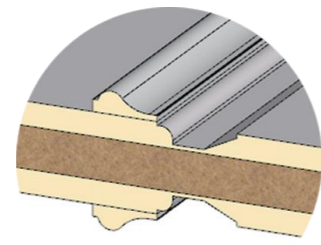

Low Profile (L)

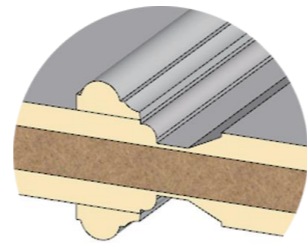

High Profile (H)

### RAISED MOULDING SERIES



SR-16



SR-17

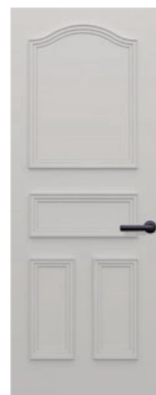

SR-18



SR-19



SR-20



SR-21



SR-22



SR-23



SR-24



SR-25

★ Sinron offers customized design services, and don't hesitate to contact our sales representatives for more information.

### DESIGN OPTIONS

#### MODERN DESIGN SERIES



SR-26



SR-27



SR-28



SR-29



SR-30



SR-31



SR-32



SR-33



SR-34

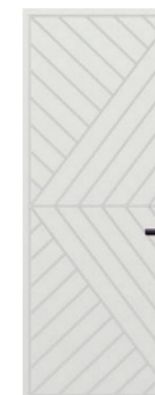

SR-35



## NATURAL VENEER OPTIONS



Mahogany



Red Oak



White Oak



Birch



Walnut



Maple



Cherry

## ENGINEERED VENEER OPTIONS



Walnut



Teak



Oak



Rosewood



Eucalyptus



Ebony



Bamboo



Bird Eyes

## NATURAL VENEER CUTS



### Crown Cut Veneer

Crown cut veneer is common veneer cutting method. This cut produces a light multicoloured and a distinctive pattern. This method is moderately priced and is available for most species of wood.

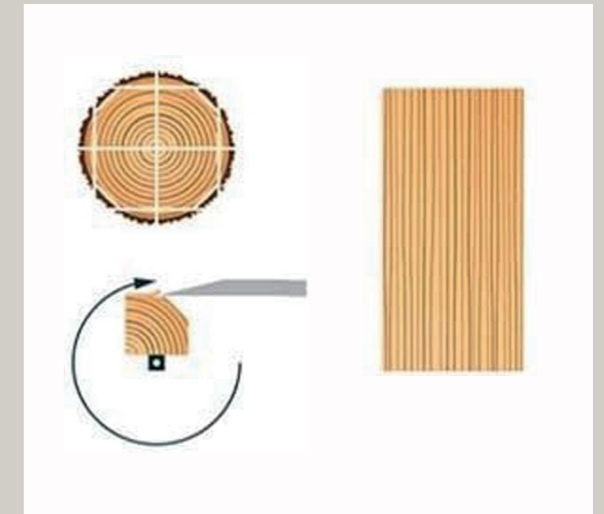

### Rift Cut Veneer

This method is generally restricted to red and white oak. A quarter log is mounted off center and cut slightly across the medullary rays common to oak, resulting in a straight grain

## STAIN COLOR OPTIONS



SG-01



SG-02



SG-03



SG-04



SG-05



SG-06



SG-07



SG-08



SG-09



SG-10

★ Sinron offers a wide variety of factory color choices. Custom color matching is also available. Simply send us a small physical sample of the finish color you desire, and we'll match it to meet your project needs.

## STANDARD PAINT COLOR OPTIONS

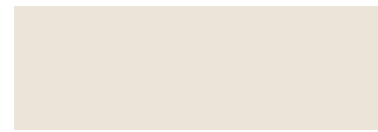

RAL 9010



RAL 9006

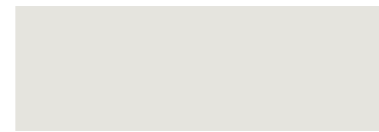

RAL 9003



RAL 1004



RAL 1019



RAL 3012



RAL 1013



RAL 6013



RAL 9018



RAL 1015



RAL 5014



RAL 9004

## GLASS OPTIONS



Clear tempered

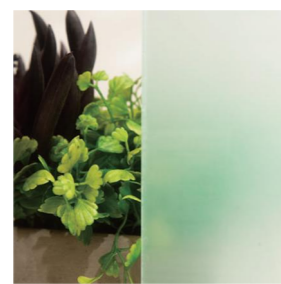

white lami

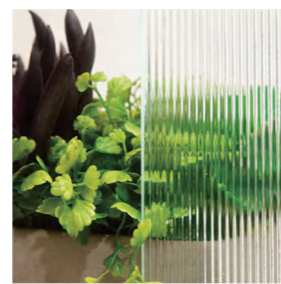

Clear reeded

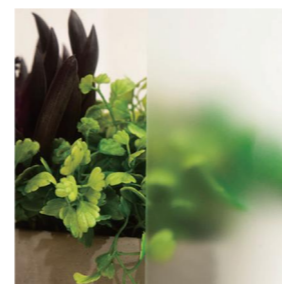

Frosted



Rainy

## CARVING & INLAY OPTIONS

Metal inlays / carving grooves can be added to many flush, raised panel, or shaker door designs by Sinron. These optional decorative elements can create one-of-a-kind door designs.

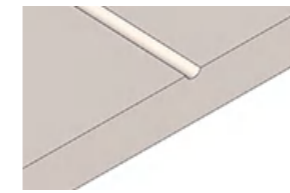

U-groove

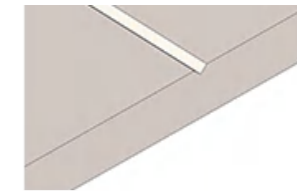

V-groove

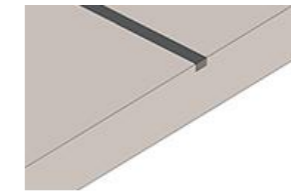

Square metal strip



T metal strip

## SKETCH FACE PATTERNS OPTIONS

Offering a unique visual impact with unlimited veneer combination and arrangement, sketch face flush door can set a tone for the interior space decoration. The veneer can be arranged and laid in different directions or varying wood species to achieve a wide array of sketch face design impression.

By creating veneer face with varying grain directions and specie types, UnaDoors' sketch face wood door can offer extraordinary visual appeal with endless design options, and leave a lasting unique door impression

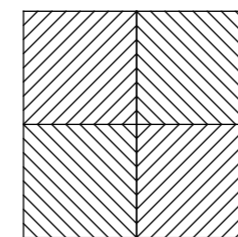

Diamond

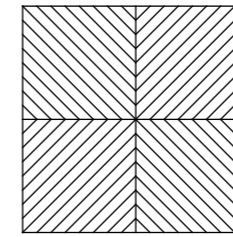

Reverse Diamond

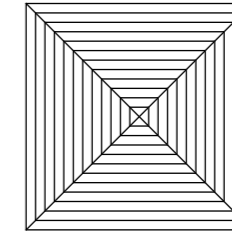

Box

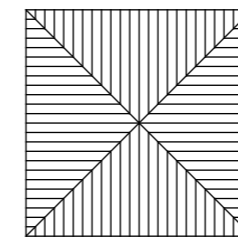

Reverse Box

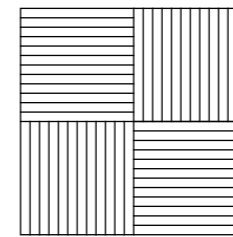

Parquet

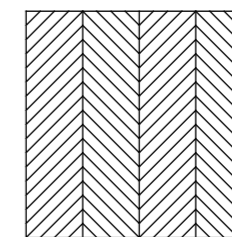

Herringbone



**SRANDARD WOOD FRAME OPTIONS**

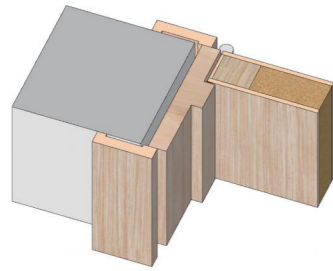

Double rabbet jamb(frame) with 2 sides flat casing

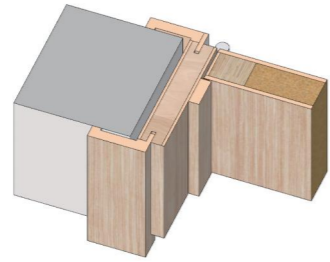

Double rabbet jamb(frame) with 2 sides adjustable casing

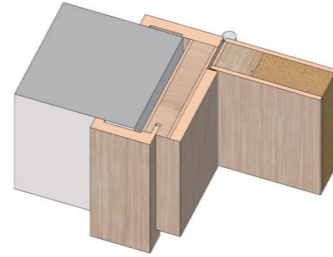

Single rabbet jamb(frame) with 1 side adjustable casing (inside flush jamb)

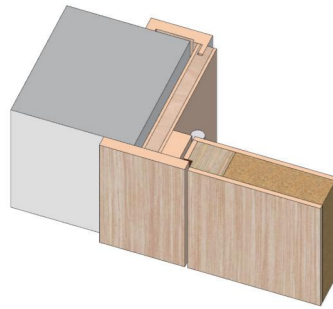

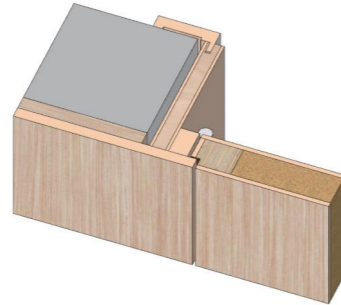

Outside flush jamb with in-swing door



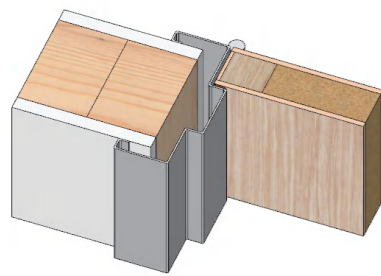

Hidden door with wall panel

**TYPICAL METAL FRAME OPTIONS**

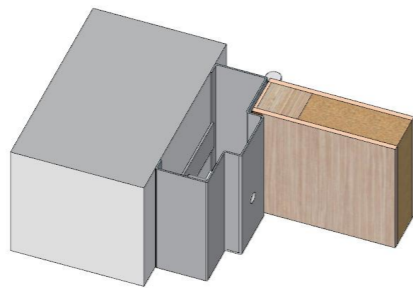

Drywall hollow metal frame (Fire-rated up to 3 hours) 



Masonry hollow metal frame (Fire-rated up to 3 hours) 

**HARDWARE OPTIONS**

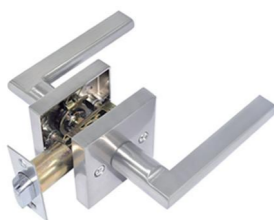

L-01

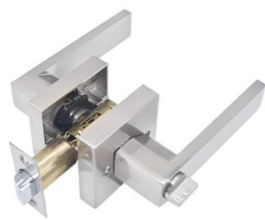

L-02

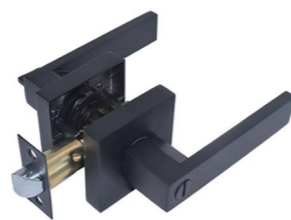

L-03



L-04



Grade2 lockset



U-Groove



U-Groove



U-Groove

**MORTISE LOCK HANDLE OPTIONS**



ML-01



ML-02



ML-03



ML-04



ML-05



Magnetic mortise lock



Mortise lock

**HINGE OPTIONS**



3.5in steel hinge



3.5in steel hinge



3in steel hinge



4.5in SS hinge



4X3in SS hinge



4X3.5in hinge



Hidden Hige

**HARDWARE AVAILABLE FINISHES**



PC Polioshed Chrome



SN Satin Nickel



MB Matt Black



PB Polished Brass

# MOULDED WOOD DOOR



6- panel moulded wood door

## MOULDED WOOD DOOR

Moulded door are classic design series, its clean lines will complement architectural style. Equally comfortable in traditional or contemporary settings, Molded doors are constructed as two skins with a core in the middle. The skin of the door is a 1/8" molded hardboard skin that is available with a smooth or textured painting surface.

Moulded door combines beauty, strength and durability. In addition, the low price is also its great advantage.

- 3-Ply construction
- Factory primed, ready to paint. Factory-paint finished also available.
- Standard thickness is 1-3/8" or 1-3/4", customized size available.
- Smooth or woodgrain textured.
- Single or double rabbet pine wood jamb to match the door.
- Pre-hung unit package is available.
- Factory-machined to meet exact requirements for door hardware.

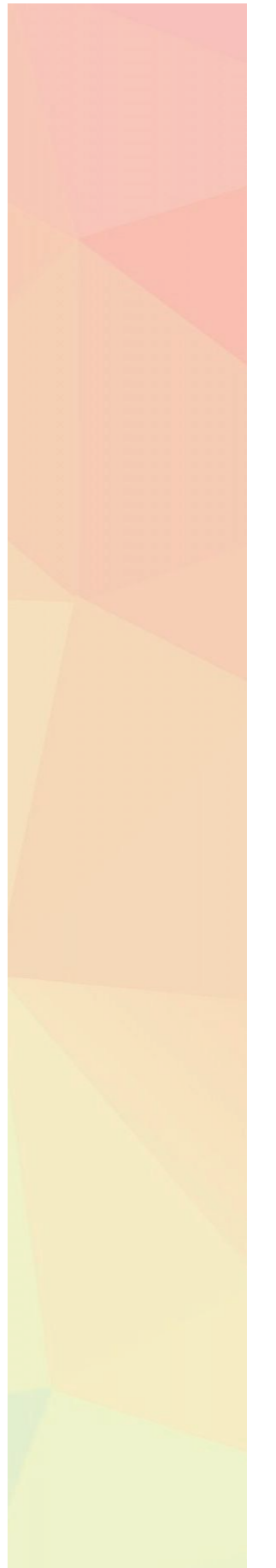

# MOULDED WOOD DOOR

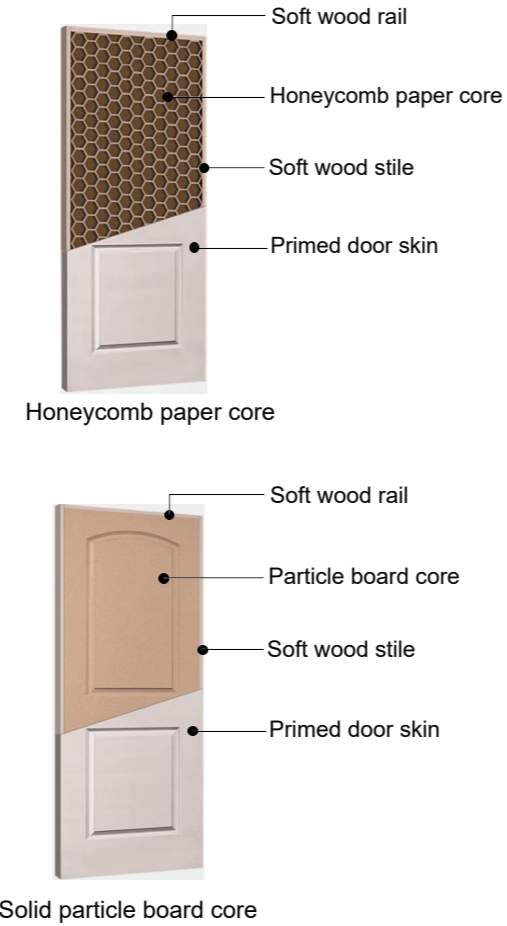
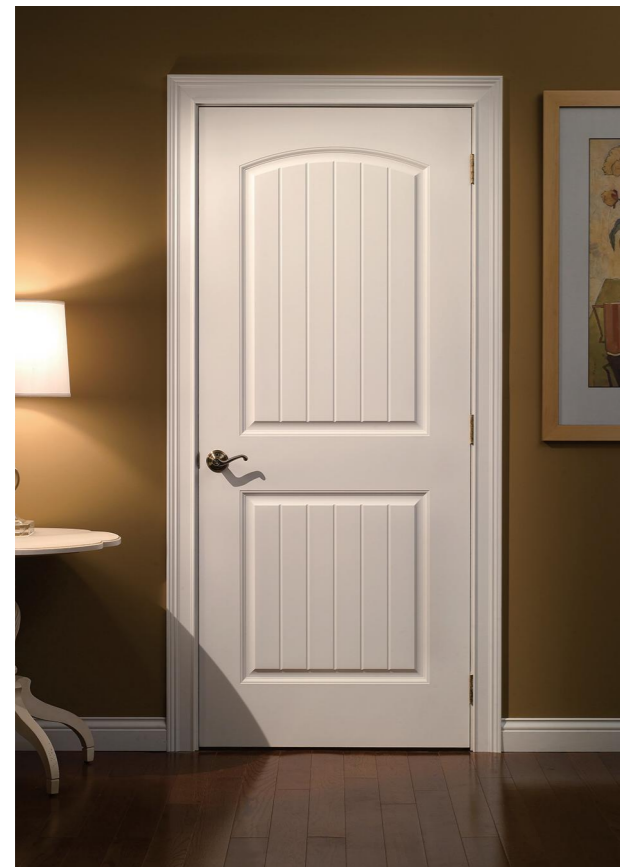

## DESIGN OPTIONS

- Smooth
- Textured

### OVOLO STICKING SERIES

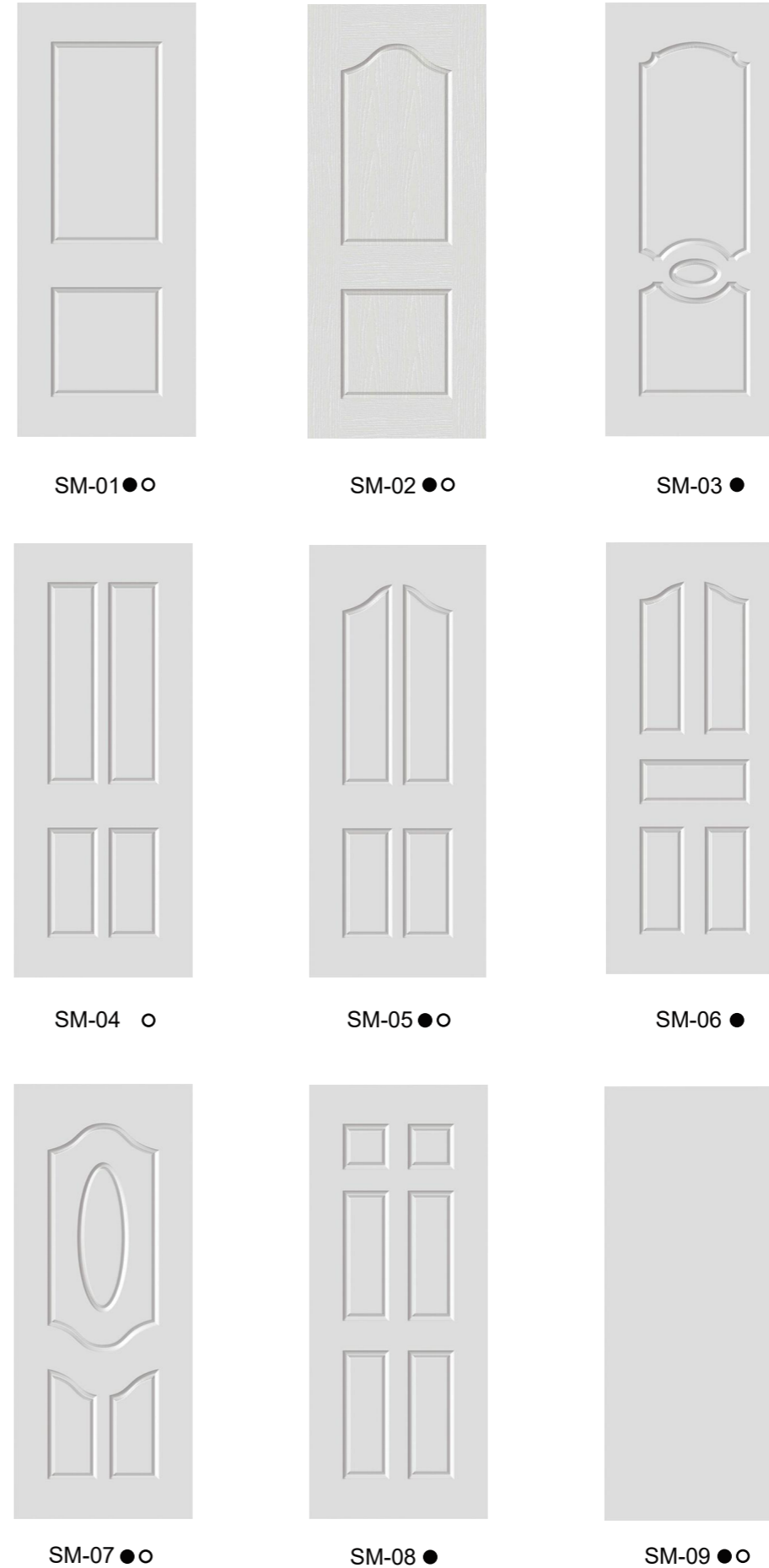

CONSTRUCTION	
General	Sandwich construction, softwood inner skeletons laminated with HDF molded skin
Size	Maximum height 96"(2438mm), maximum width 38"(965mm)
Thickness	Standard thickness as 1-3/8"(35mm) or 1-3/4"(45mm), customized size available
MOULDED DOOR SKIN	
HDF	1/8" (3mm) HDF with white primed
Sticking	Ovolo sticking or craftsman sticking
Face	Smooth or wood grain textured
SKELETON & CORE	
Skeleton	Finger-joint softwood skeleton
Core	Honeycomb paper core or particle board core
FINISH OPTIONS	
White primed or painted, PU or water-based paint available	

# DESIGN OPTIONS

## CRAFTSMAN STICKING SERIES

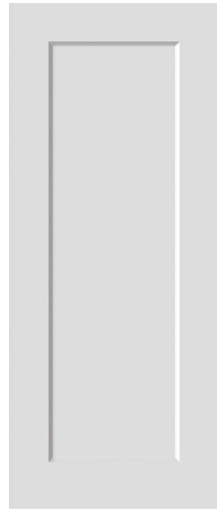

SM-10 ●

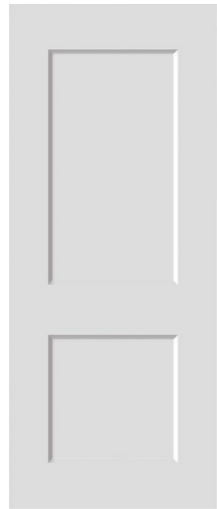

SM-11 ●

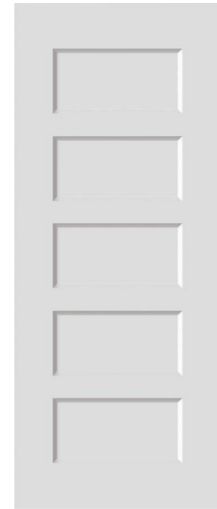

SM-12 ●



SM-13 ●

## GROOVE SERIES



SM-14 ●

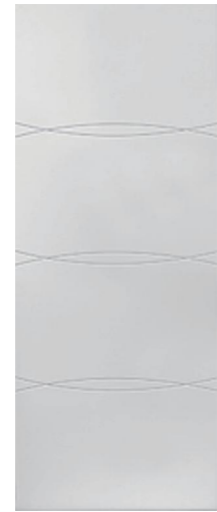

SM-15 ●

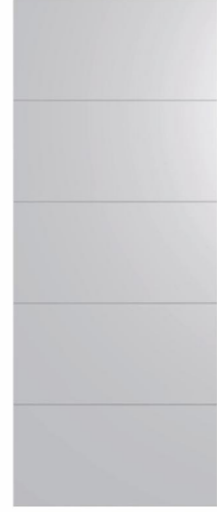

SM-16 ●



SM-17 ●



SM-18 ●



SM-19 ●



SM-20 ●

★ Customized Design Available

## DOOR FACE



Smooth



Textured

## JAMB/FRAME



Primed finger-joint double rabbet jamb



Primed finger-joint double rabbet jamb



Primed finger-joint astragal

## CASING



C-01

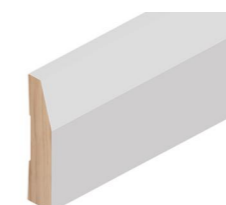

C-02

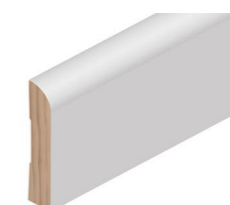

C-03

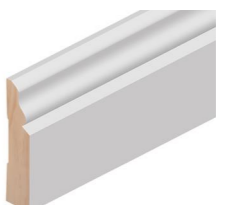

C-04

# HARDWARE OPTIONS

## LOCK OPTIONS



Lever lock-1



Lever lock-2



Lever lock-3



Lever lock-4



Grade2 lockset



Knob Lock



Deadbolt

## HINGE OPTIONS



3.5in steel hinge



3.5in steel hinge



3in steel hinge



4in SS hinge

## OTHER HARDWARE OPTIONS



Bi-fold Door



Barn Door



Sliding Door



Pocket Door



Groove design pocket door



Bi-fold door



Swing door



Sliding door

# SLIDING BARN DOOR



## SLIDING BARN DOOR

Sliding barn doors were once a farm necessity, but today are being repurposed to create beautiful and stylish living Spaces. Sliding barn doors are great space-saving solutions for pantries, laundry rooms, master bathrooms, or any interior space where every square foot counts.

We closely work with professional barn door hardware company to develop one-stop solution for your projects.

- Wide selection of door type options, stile&rail, flush and glass door etc. customized also available
- Various surface treatment options, painted, primer and veneer stained, HPDL also available
- A full array of hardware options
- Various glass designs are available
- Custom made to fit any opening, including oversized and thick-opening applications
- Limited 3-year warranty for interior use
- Doors meet WDMA/AWS premium grade quality standards
- Factory-machined to meet exact requirements for door hardware

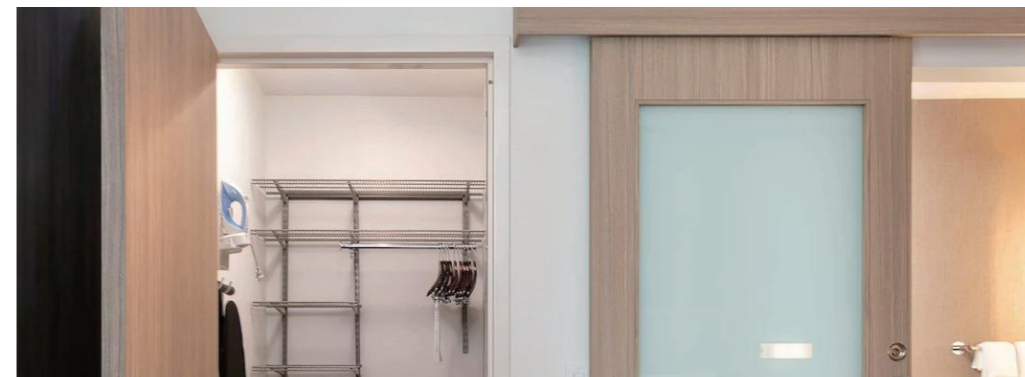

# BARN DOOR-CLASSIC SERIES

## DESIGN OPTIONS

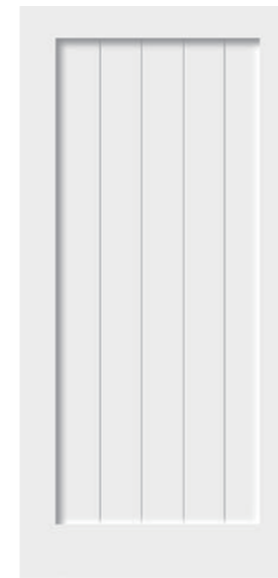

SCB-01



SCB-02



SCB-03



SCB-04



SCB-05



SCB-06



SCB-02  
Z Brance Style Barn Door

# BARN DOOR-HOTEL SERIES



Hotel Bathroom Barn Door With Circular Glass Panel



Painted mirror barn door



Painted 4-lite glass barn door

Hampton Inn Hotel

Spring Hill Hotel

Hilton Hotel

Marriot Hotel



Full-Lite laminated glass barn door (HPDL)

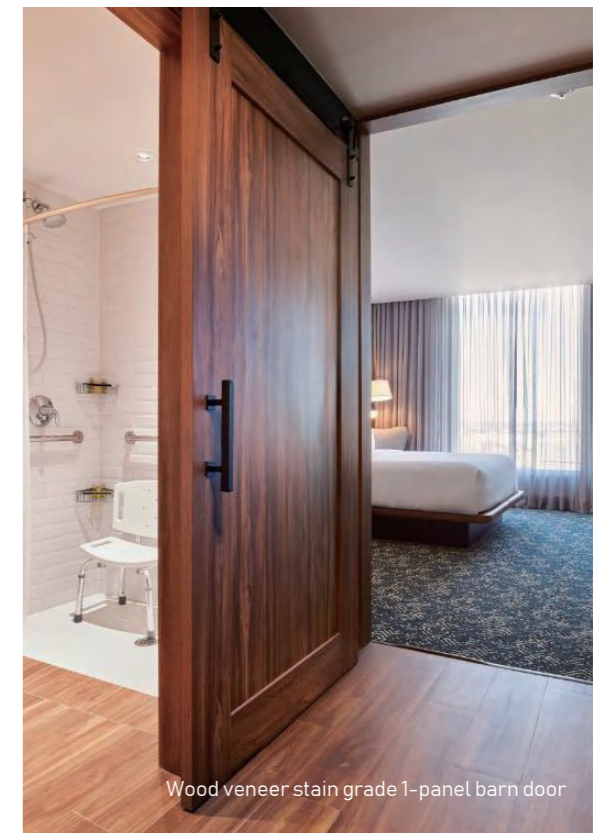

Wood veneer stain grade 1-panel barn door

# BARN DOOR- MODERN SERIES

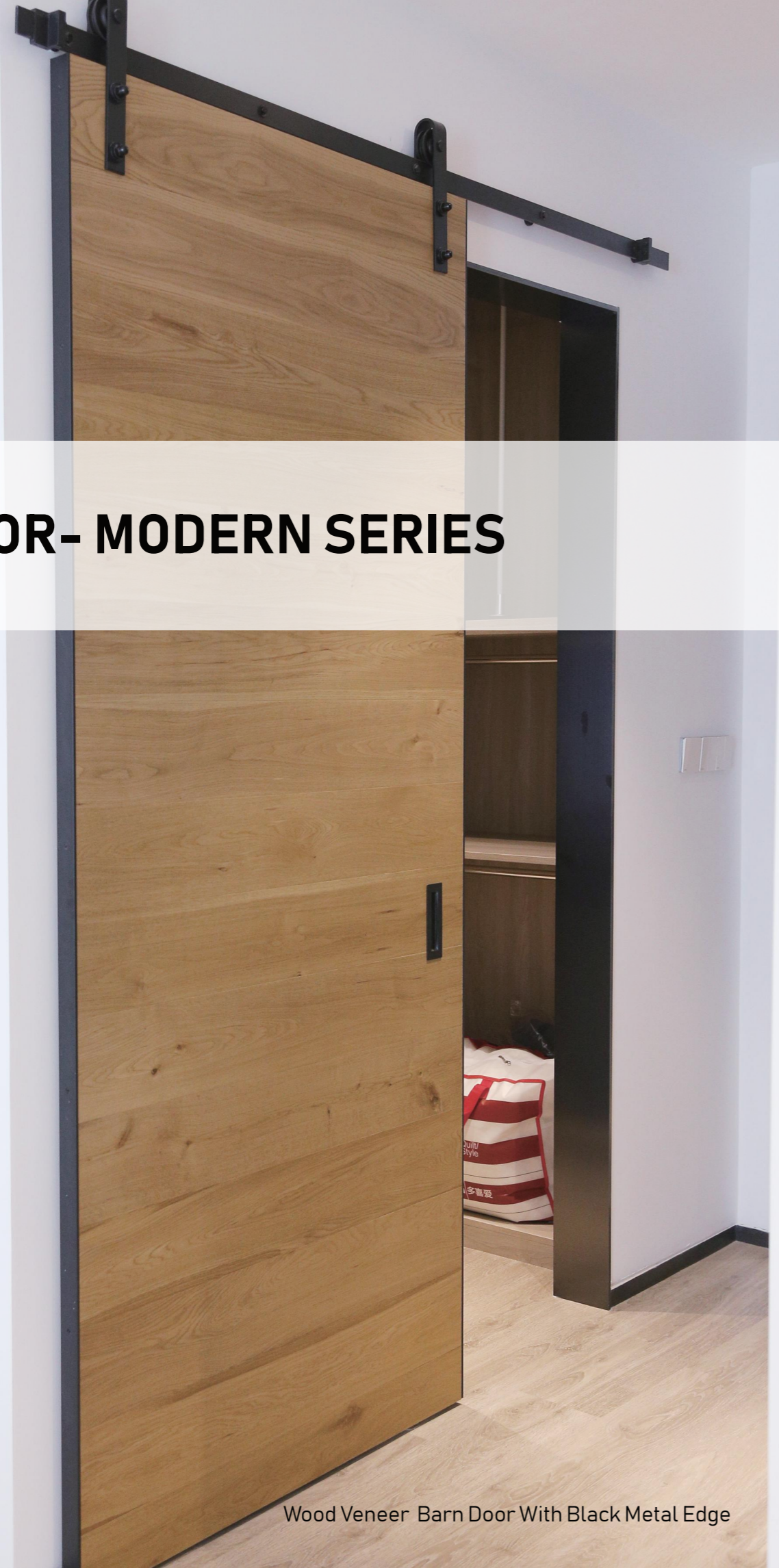

Wood Veneer Barn Door With Black Metal Edge



Groove Style Barn Door



SGB-01



SGB-02



SGB-03



Shaker Style Barn Door



SKB-01

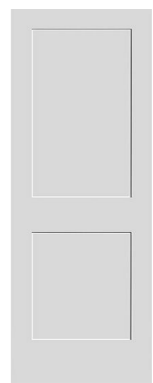

SKB-02

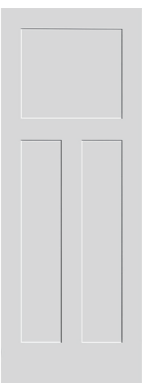

SCB-03



SCB-04

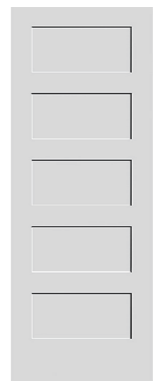

SCB-05

### GLASS OPTIONS



Clear Tempered



White Lami



Clear Reeded



Frosted



Rainy

### STANDARD PAINT COLOR OPTIONS

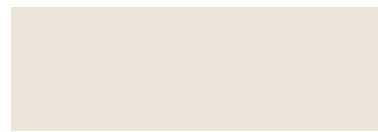

RAL 9010



RAL 9006

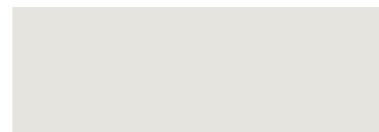

RAL 9003



RAL 1004



RAL 1019



RAL 3012



RAL 1013



RAL 6013



RAL 9018



RAL 1015



RAL 5014



RAL 9004

### WOOD VENEER OPTIONS



Mahogany

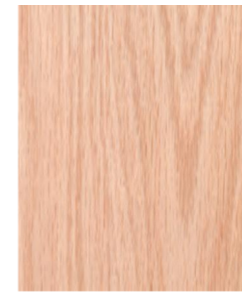

Red Oak



White Oak



Birch



Walnut



Maple



Cherry

### STAIN COLOR OPTIONS



SG-01



SG-02

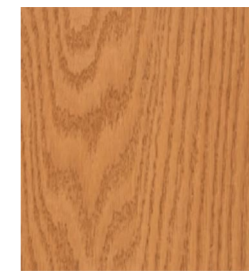

SG-03



SG-04



SG-05



SG-06



SG-07



SG-08



SG-09



SG-10

★ Sinron offers a wide variety of factory color choices. Custom color matching is also available. Simply send us a small physical sample of the finish color you desire, and we'll match it to meet your project needs.

# SLIDING BARN DOOR HARDWARE

## TRACK SYSTEM



TS-01



TS-02



TS-03

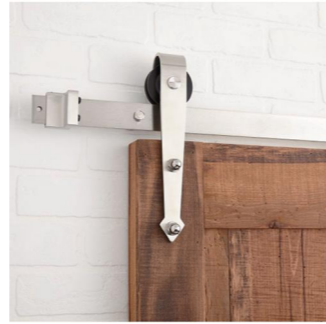

TS-04



TS-05

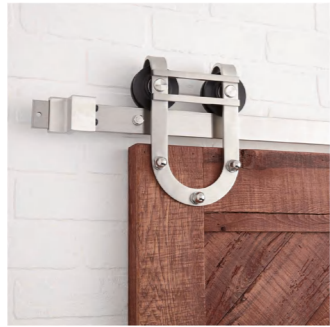

TS-06

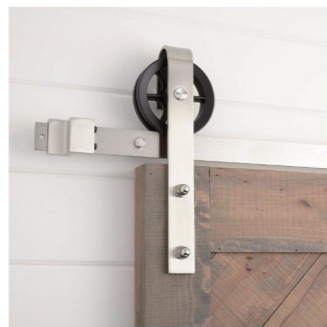

TS-07



TS-08

## DOOR HANDLE



BH-01



BH-02



BH-03



BH-04



BH-05



BH-06



BH-07



BH-08

## FLUSH PULL HANDLE



Black Flush Pull



Stainless Steel Flush Pull



Oval Flush Pull



Round Flush Pull

## DOOR LOCKSET



Stainless Steel Vintage Lock



Black Vintage Lock



Black Buckle Lock

## DOOR GUIDE



Standard Floor Guide



Vintage Wall Mounted Door Guide



Wall Mounted Door Guide

## ADDITIONAL PRODUCT INFORMATION

### Door Machining Options

Sinron will machine your door for any architectural builder's hardware requirement. We use advanced machinery and programming to deliver doors that are ready to accept the hardware your application requires. Contact your Sinron representative or visit the Technical Info section at our Web site to obtain more detailed information about our machining capabilities.

### Knocked Down Pre-hung Doors

Sinron offers knocked down pre-hung doors that are easy to assemble and to install. Door slabs and Jambs are precisely pre-machined to exact match each other during assembly. Jambs and casings are carefully packed and shipped together with door slabs. Every piece is labeled to make assembly and installation quick and easy at the job site.

### Pre-hung

Sinron pre-hung doors are built using premium construction techniques, high quality craftsmanship, and complete flexibility. We build our pre-hung units to order and can supply jambs in any width, for any size door. Our automated, precise machinery ensures every pre-hung unit is high quality and machined exactly to your specifications.



### Knocked Down Pre-hung Doors

Proper handling, storage, finishing and installation are important steps in preserving a quality appearance and maintaining warranty coverage for your TruStile doors. TruStile has developed detailed care and handling instructions for our MDF, and wood doors. These instructions can be found in the Care and Handling section of our Web site at [www.trustile.com](http://www.trustile.com).

### Storing & Handling

- Avoid leaving doors in direct sunlight. Prolonged exposure to direct sunlight will discolor the wood and bake on the plastic film which protects the glass during the finishing process.
- Store doors flat on a level surface in a dry, well ventilated interior space
- Keep doors clean.
- If the doors are to be stored on the job site, the entire door including top and bottom edges must be sealed with a clear or pigmented based sealer to prevent moisture absorption. All six sides of the door must be properly sealed for warranty to apply

### Warranty

All Sinron wood doors are manufactured to the highest quality and craftsmanship standard, and are backed by limited 3 years warranties against defects in workmanship and materials. Our detailed warranties can be accessed in the resource section of our website at [www.sinronindustries.com](http://www.sinronindustries.com).



**APPLICATION CASE**



**Cooperated Brands**

